

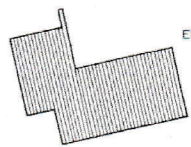

1:1000

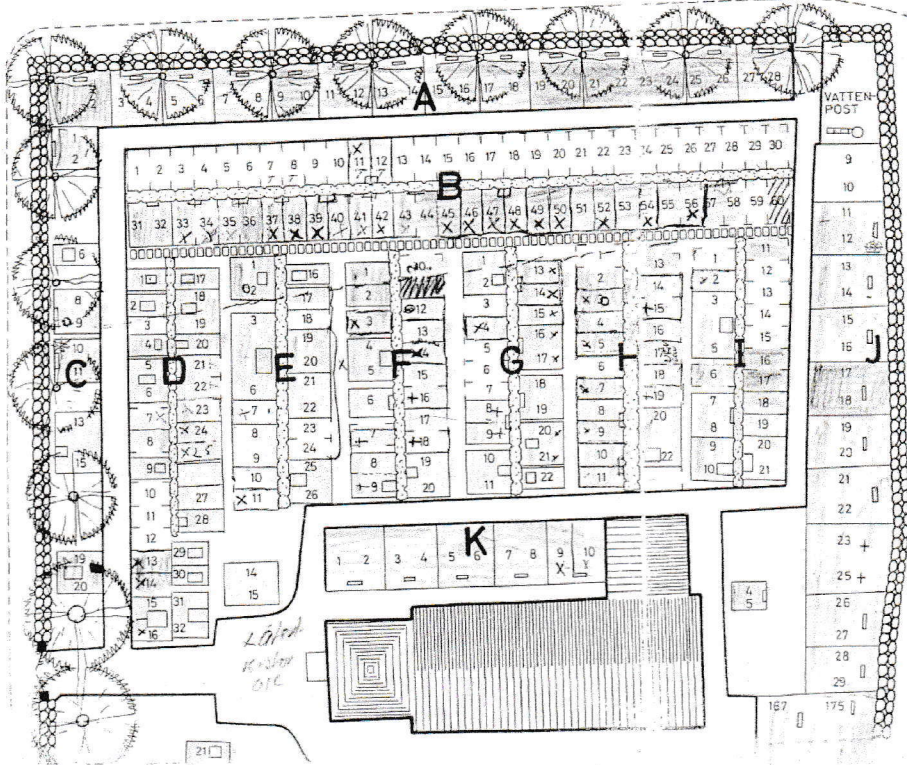





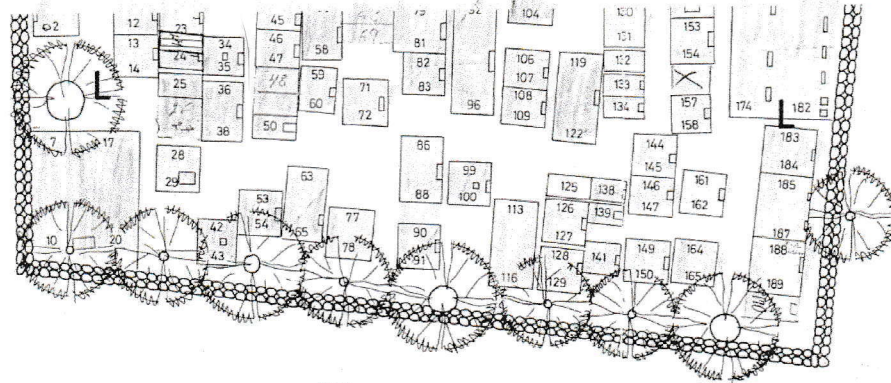

EKONOMIBYGGNAD

1:1000

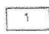

BILPARKERING

**BETECKNINGAR:**

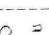
-  BEFINTLIG GRAV
-  FÖRESLAGEN GRAV 125 X 250 CM.
-  STENMUR
- A** KVARTERSBETECKNING
-  STENPLATTEGÅNG
-  TRÄD
-  VAG
-  = urna

GRAVVÄRDSSYMBOLER ÄR EJ SKALENLIGT INRITADE

SKALA 1:200



KARTA ÖVER  
**VÄSTRA GERUMS KYRKOGRÅF**  
 SKARABORGS LÄN  
 upprättad den 14 juni 1973  
*Olof Robertsson*  
 Ingenjör